

**S T U D I O S**

**M A N C H E S T E R**

**Space Studios Manchester** is a purpose built facility for high end TV, film & commercial production.

Located in **central Manchester**, the site features over **85,000 sq ft** of production space across **6 sound stages**, ranging from **9,000 sq ft to 30,000 sq ft** plus purpose designed dressing and make up facilities, laundry, prop storage / workshops, onsite catering and extensive secure parking.

## OVERVIEW OF THE SITE

- 6 purpose built production stages
- Production offices ranging from 409 sq ft to 1,851 sq ft.
- 25,000 sq ft prop storage / workshop
- All-weather covered access points for all stages with adjacent secure overnight parking
- Media Ingest & content storage / distribution via superfast fibre connectivity
- Hi speed Wi-Fi connectivity / 3-phase and domestic power
- 24/7 security
- Extensive onsite parking including unit base with power & water
- Screening and conference rooms
- Runners available to hire
- Onsite catering and dining

## CLIENTS

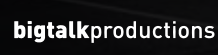

## TRAVEL & LOCATION



Manchester Piccadilly is a 5 minute taxi ride away.



Ashburys station is 5 mins walk away.



Space Studios is a 5 minute drive from the motorway.



Manchester Airport is 25 mins away by car or train.

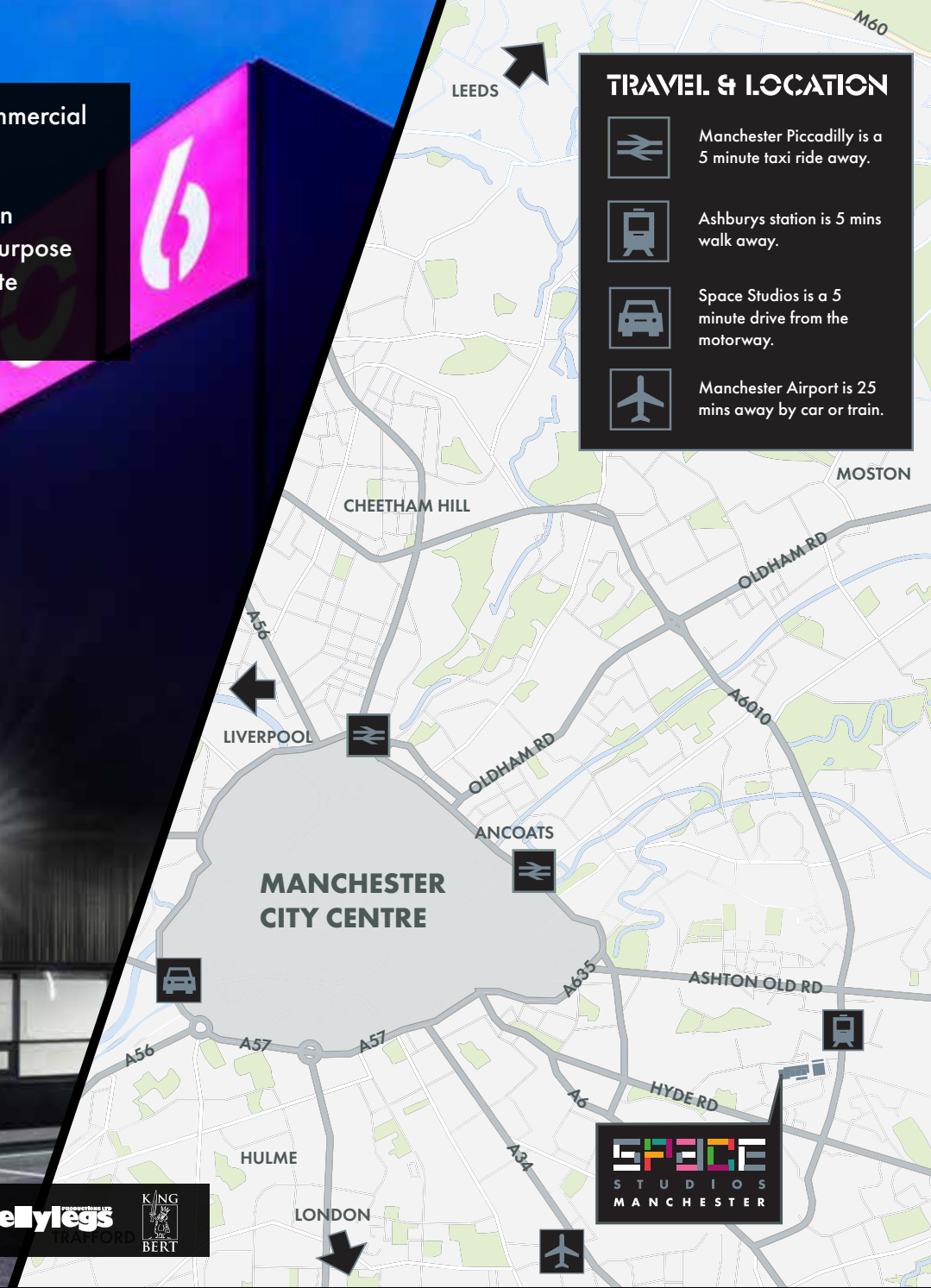

## NEW FOR 2018 - SPACE STUDIOS EXPANSION

**Space Studios Manchester** has recently opened a purpose built **30,000 sq ft** production stage as part of a site expansion that also includes business units dedicated to providing technical support from a range of TV supply businesses, unit base parking, workshops & production offices.

This 360 degree infrastructure, delivering a comprehensive supply chain, enhances Space Studios offering to both onsite clients and the wider North West & UK screen content production sector.



For further information or to arrange a viewing of the new Space expansion please email [enquiries@spacestudiosmanchester.co.uk](mailto:enquiries@spacestudiosmanchester.co.uk)





# RECENT FILMOGRAPHY



**COLD FEET - SERIES 6&7**  
- BIG TALK FOR ITV



**THE A WORD - SERIES 1 & 2**  
- FIFTY FATHOMS FOR BBC ONE



**CORONATION STREET**  
- ITV



**CRADLE TO GRAVE**  
- ITV STUDIOS FOR BBC TWO



**ROVERS**  
- JELLYLEGS FOR SKY ONE



**MOUNT PLEASANT**  
- TIGER ASPECT FOR SKY 1



**RATBURGER**  
- LITTLE BERT FOR SKY 1



**LET IT SHINE (OPENING)**  
- BBC ONE

# SITE MAP



## SPACE 01

11,194 sq ft Sound Stage

## SPACE 02

10,634 sq ft Sound Stage

## SPACE 03

10,128 sq ft Sound Stage

## SPACE 0-4

10,128 sq ft Sound Stage

## SPACE 05

8,991 sq ft Sound Stage

## SPACE 06

30,000 sq ft Sound Stage

**SPACE 01**

**1040 sq m / 11,194 sq ft Sound Stage**

**Length: 42.6 m / 139 ft 2 in**

**Width: 24.50 m / 80 ft 4 in**

**Height (to rigging point): 9.15 m / 30 ft**



**SPACE 02**

**994 sq m / 10,699 sq ft Sound Stage**

**Length: 40.75 m / 133 ft 8 in**

**Width: 24.50 m / 80 ft 4 in**

**Height (to rigging point): 9.15 m / 30 ft**

**SPACE 03**

**938 sq m / 10,096 sq ft Sound Stage**

**Length: 29.85 m / 97 ft 11 in**

**Width: 31.98 m / 104 ft 11 in**

**Height (to rigging point): 6.64 m / 20 ft**

**SPACE 0-1**

**943 sq m / 10,150 sq ft Sound Stage**

**Length: 29.60 m / 97 ft 1 in**

**Width: 32.31 m / 106 ft 11 in**

**Height (to rigging point): 6.64 m / 20 ft**

**SPACE 05**

**826 sq m / 8,991 sq ft Sound Stage**

**Length: 29.60 m / 97 ft 1 in**

**Width: 28.10 m / 92 ft 2 in**

**Height (to rigging point): 6.64 m / 20 ft**

**SPACE 06**

**2771 sq m / 29,092 sq ft Sound Stage**

**Length: 64.6 m / 212 ft**

**Width: 42.9 m / 141 ft**

**Height (to rigging point): 12.16 m / 40 ft**

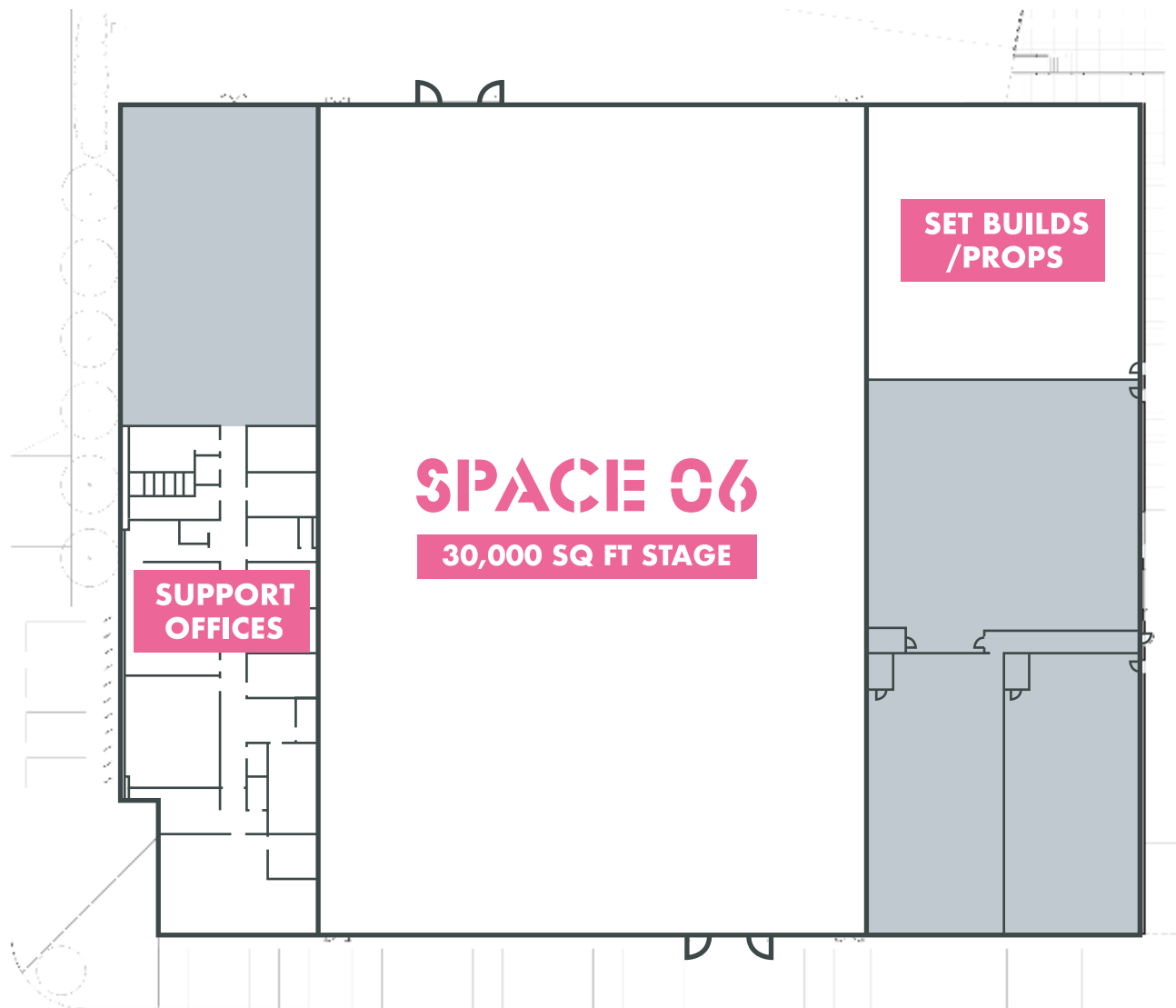

## SPACE 06

- 2 x 400amp power available, powerlock 3 phase plus various other outlets available
- i-beam for easy rigging
- Dedicated service yard with power and water
- Enhanced reverberation and acoustic performance
- Silent Cool Air-Conditioning
- Wi-Fi & hard wired IT

Space Studios offers dedicated independent support directly adjacent to the stage, includes a full suite of dressing rooms, shower facilities and an onsite laundry, as well as extensive flexible support spaces providing tenants with conveniently located production offices.

Stage access via two separate Stage Doors 6m (H) x 6.085m (W)

**SUPPORT SPACE - PRODUCTION OFFICES**

Available furnished if required / bespoke internet and voip packages available on request

## SUPPORT SPACE - CONFERENCE ROOM





## SUPPORT SPACE - SCREENING ROOM



# SPACE CAMP CATERING



# WORKSHOPS



# UNIT BASE PARKING





**STUDIOS  
MANCHESTER**



**enquiries@spacestudiosmanchester.co.uk**



**0161 205 5508**



**@SpaceStudiosMcr**



**SpaceStudiosMcr**



**@SpaceStudiosMcr**

