

# UNIT BASE PARKING



## SPACE STUDIOS MANCHESTER HAS 158,000 SQ FT OF UNIT BASE PARKING

- Space Studios has over 158,000 sq ft of available unit base parking available to hire for either productions working on site or on location across the North West.
- The unit base parking features:
- 24/7 Access
  - 24/7 Security
  - 158,000 sq ft of available space
  - Located directly adjacent to main Space Studios Manchester site
  - Easy access to motorway network
  - 10 minutes from Manchester City Centre



## UNIT BASE 1 - THE WENLOCK

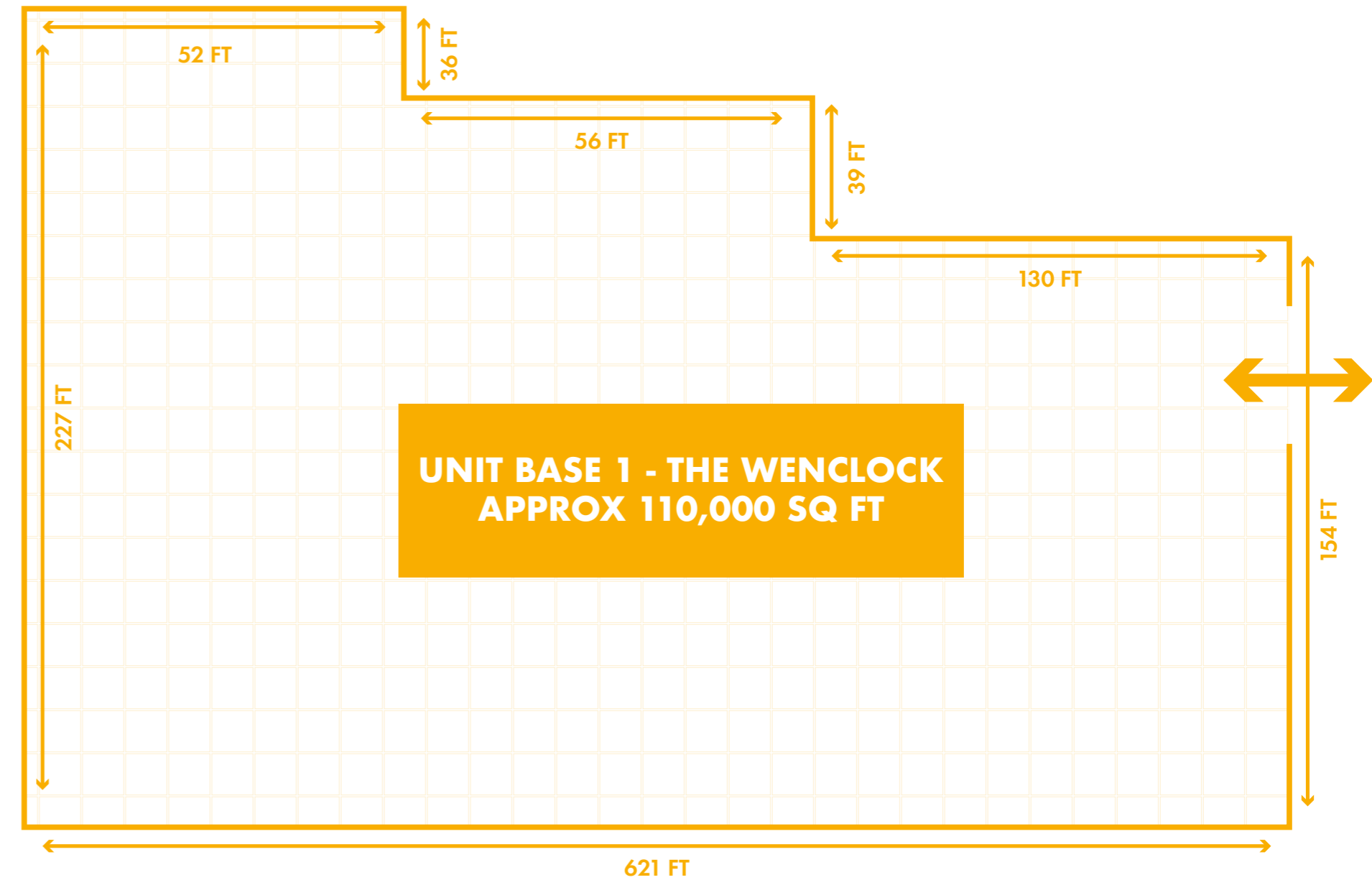

**UNIT BASE 2 - THE VAUGHAN**

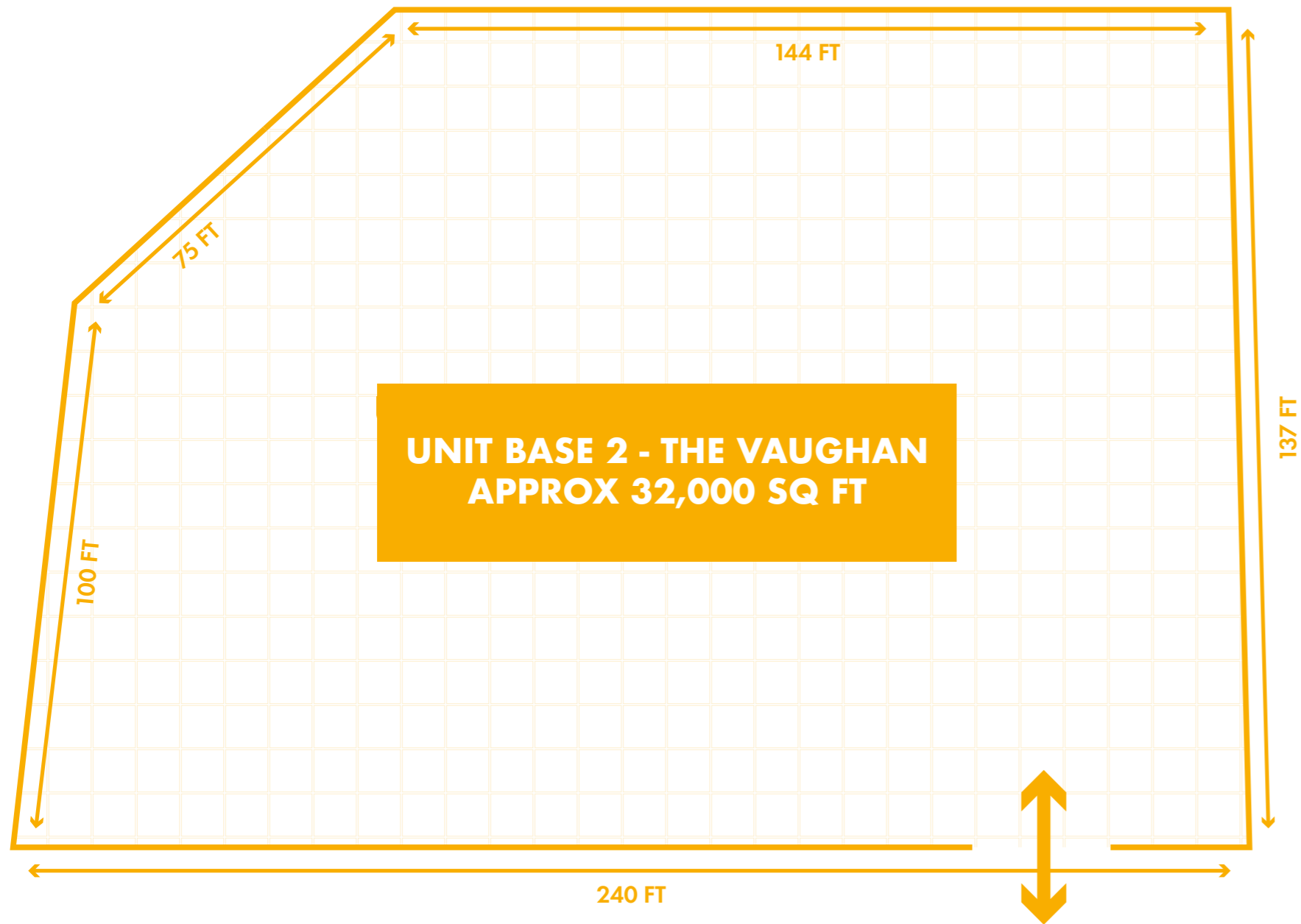

**UNIT BASE 2 - THE VAUGHAN  
APPROX 32,000 SQ FT**

**UNIT BASE 3 - THE BENNETT**

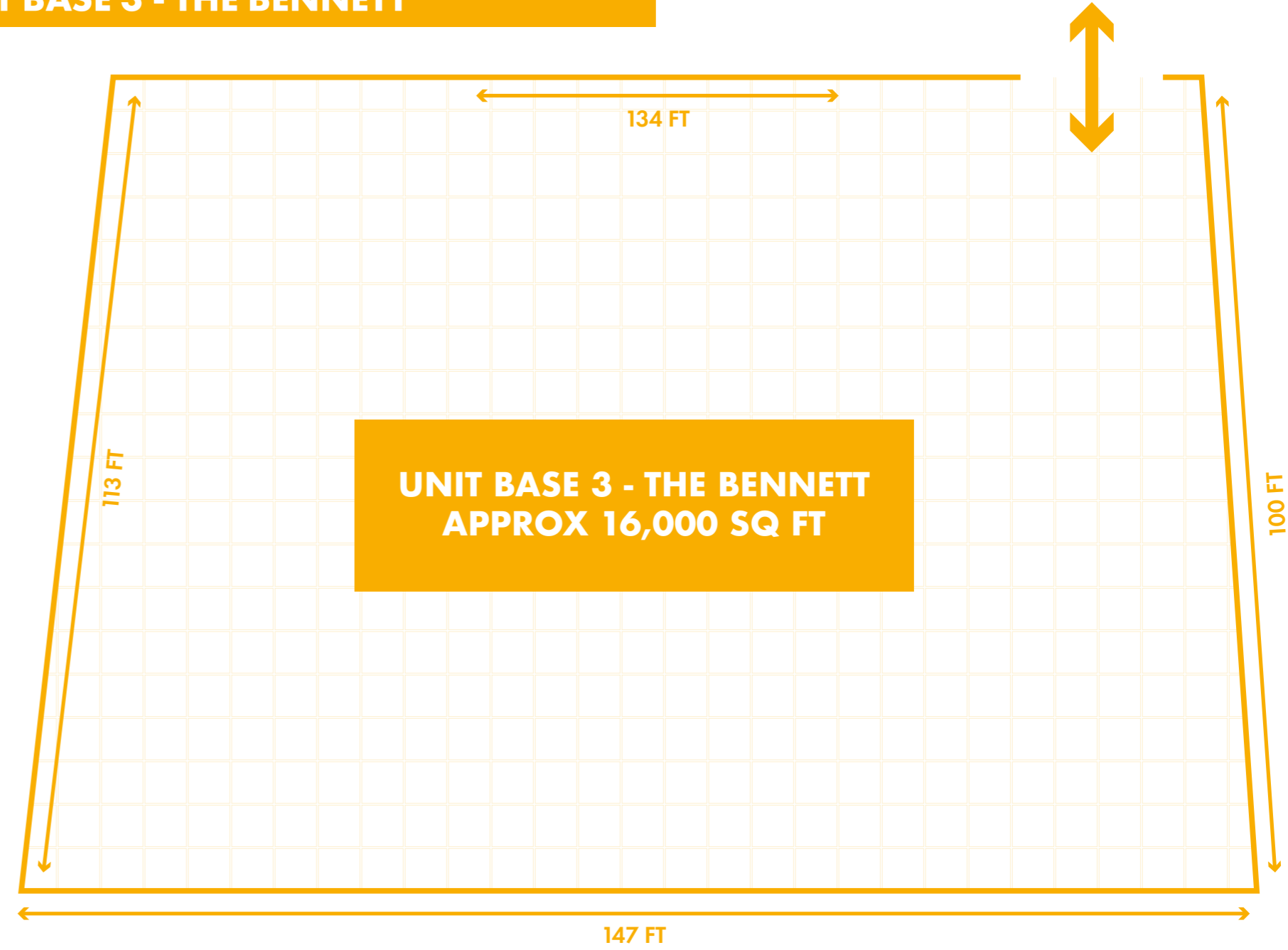

**UNIT BASE 3 - THE BENNETT  
APPROX 16,000 SQ FT**

# SITE MAP

## GROUND FLOOR

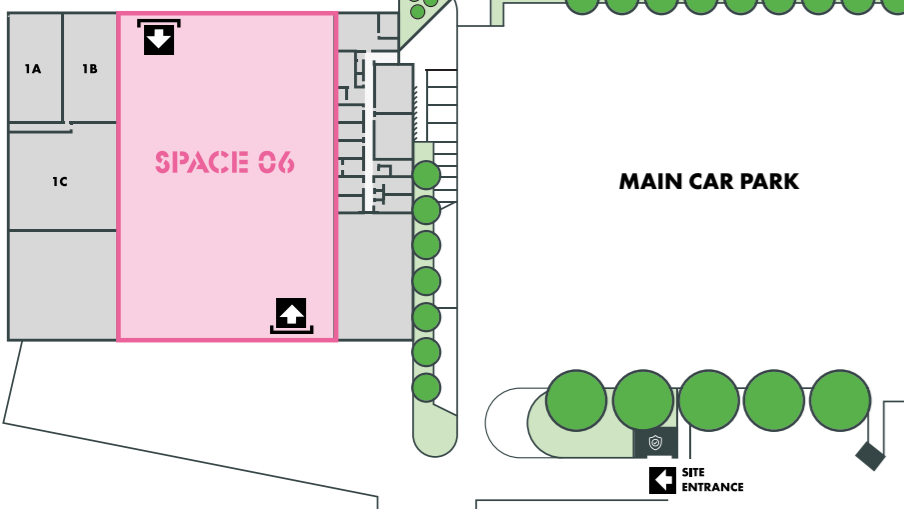
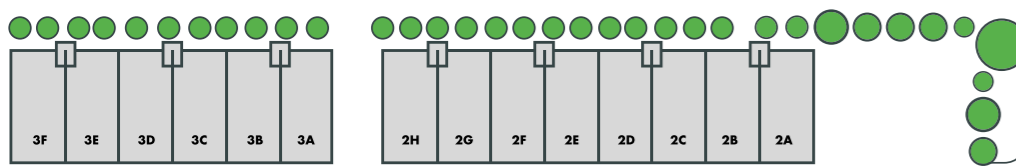

UNIT BASE 2 - THE VAUGHAN

## FIRST FLOOR

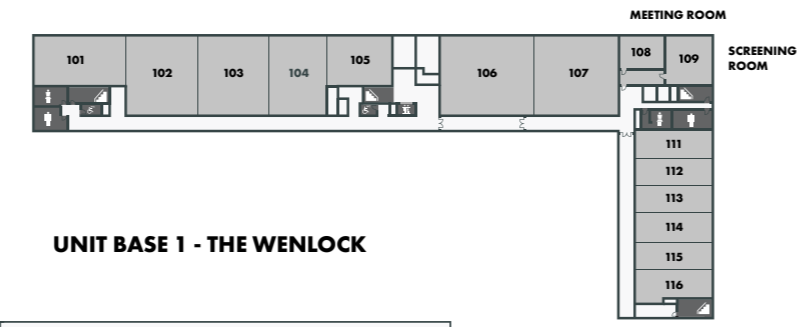

UNIT BASE 1 - THE WENLOCK

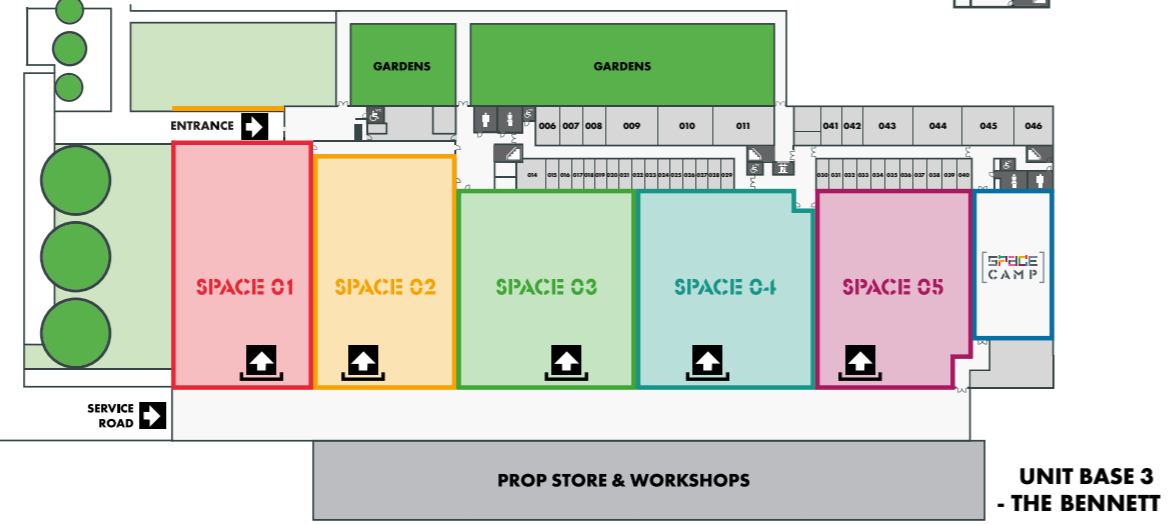

0161 205 5508



enquiries@spacestudiosmanchester.co.uk



@SpaceStudiosMcr



@SpaceStudiosMcr

